

3-12

7丁目324号

3-12 丈量図

$s = 1/300$

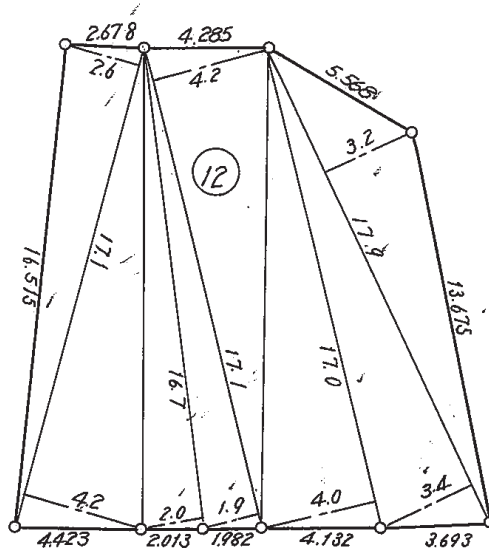
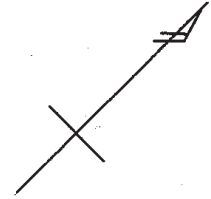

番号	底辺 (M)	高さ (M)	面積 (㎡)
12	17.1 ✓	2.6 ✓	44.46 ✓
	" ✓	4.2 ✓	71.82 ✓
	16.7 ✓	2.0 ✓	33.40 ✓
	17.1 ✓	1.9 ✓	32.49 ✓
	" ✓	4.2 ✓	71.82 ✓
	17.0 ✓	4.0 ✓	68.00 ✓
	17.9 ✓	3.4 ✓	60.86 ✓
	" ✓	3.2 ✓	57.28 ✓
計			440.13 ✓
1/2			220.06 ✓