

北区ひよどり台2丁目34番 6

(2~3)

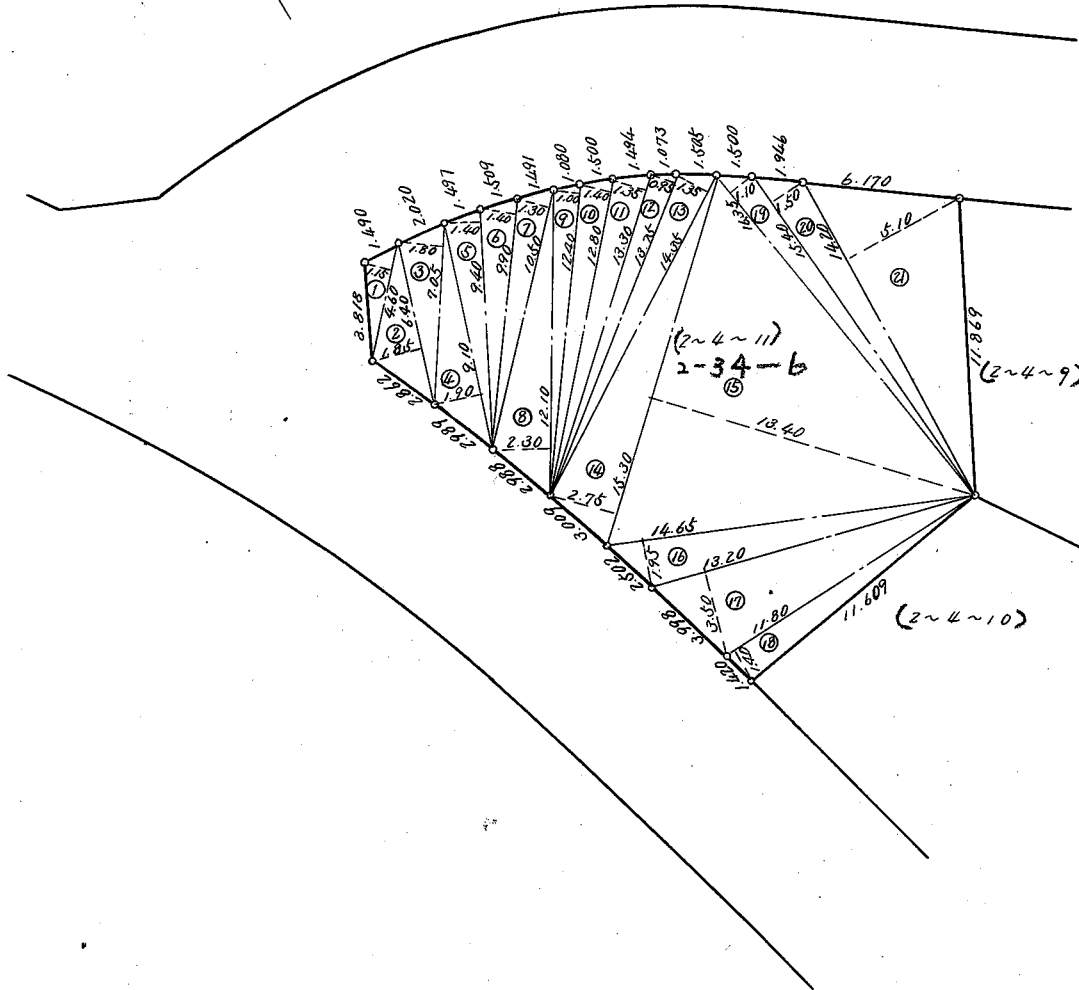

番号	底辺	垂線	倍面積
(2~4~11) 2-34-6			
1	4.60	1.15	5.2900
2	6.40	1.85	11.8400
3	7.05	1.80	12.6900
4	9.10	1.90	17.2900
5	9.40	1.40	13.1600
6	9.90	1.40	13.8600
7	10.50	1.30	13.6500
8	12.10	2.30	27.8300
9	12.40	1.00	12.4000
10	12.80	1.40	17.9200
11	13.30	1.35	17.9550
12	13.75	0.95	13.0625
13	14.35	1.35	19.3725
14	15.30	2.75	42.0750
15	15.30	13.40	205.0200
16	14.65	1.95	28.5675
17	13.20	3.50	46.2000
18	11.80	1.40	16.5200
19	16.35	1.10	17.9850
20	15.40	1.50	23.1000
21	14.20	5.10	72.4200
計			648.2075
1/2			324.10 m ²