

B-6 ① 丈量図

S = 1/300

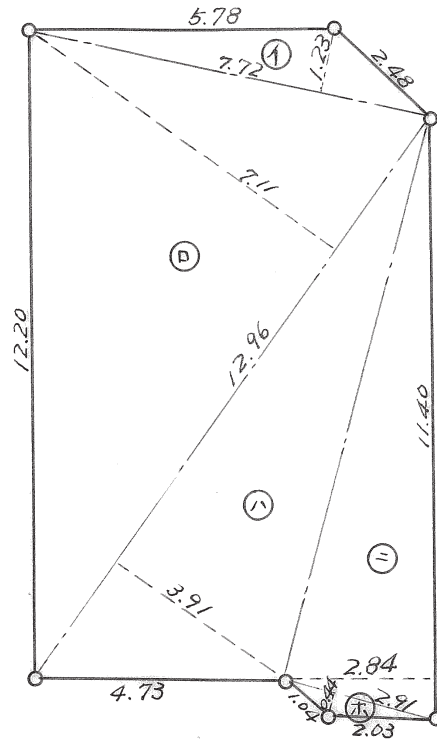
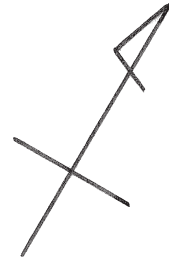

記号	算式	倍面積	面積
①	7.72 <sup>間</sup> × 1.23 <sup>間</sup>	9.4956	
②	12.96 × 7.11	92.1456	
③	12.96 × 3.91	50.6736	
④	11.40 × 2.84	32.3760	
⑤	2.91 × 0.44	1.2804	
計		185.9712	92.98 <sup>坪</sup>