

A-II ① 丈量図 $s = 1/300$

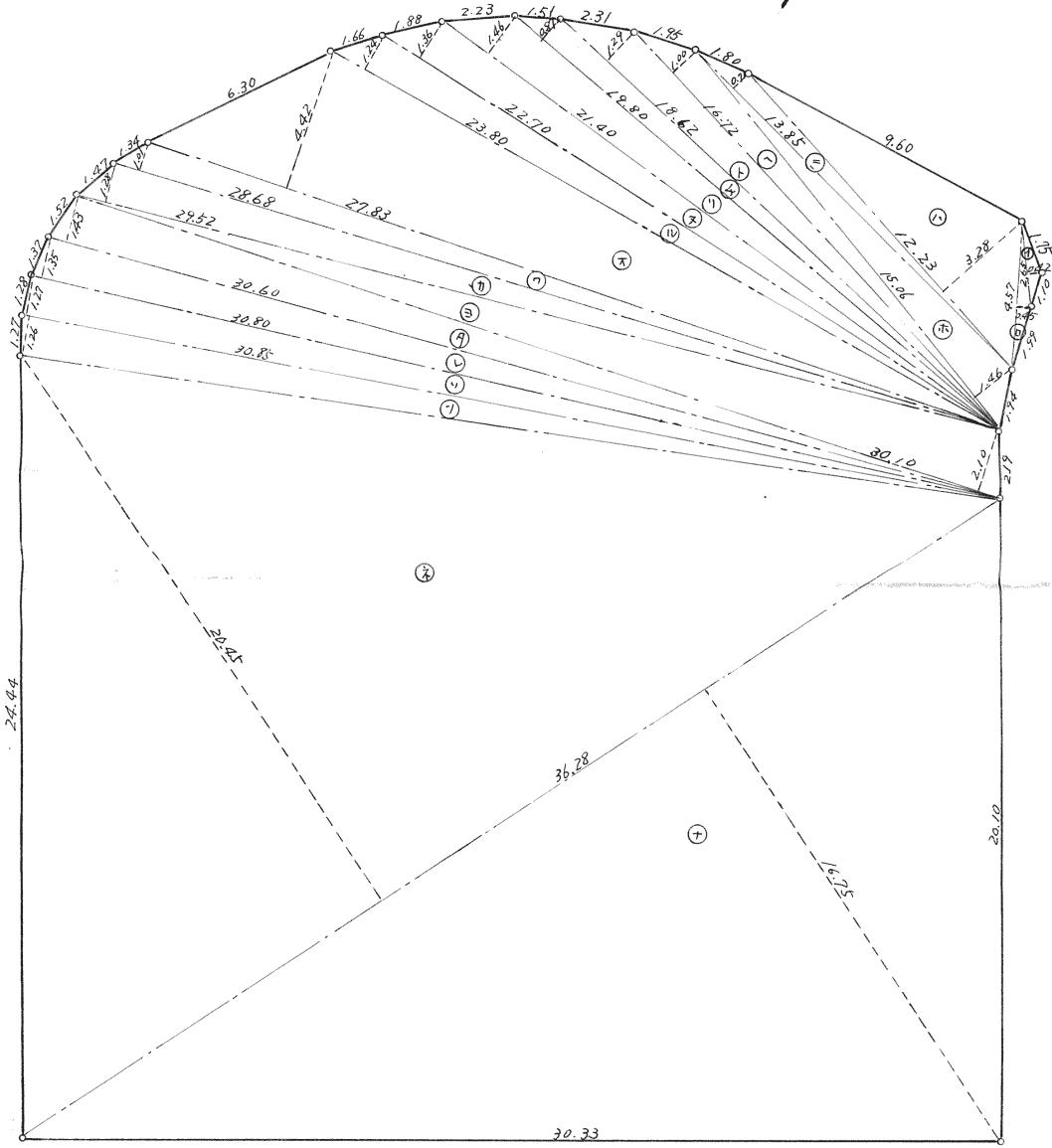

記号	算式	倍面積	面積	①			
				27.83 × 4.42	123.0086		
①	2.65 × 0.42	1.1130		⑦	28.68 × 1.01	28.9668	
②	4.57 × 0.45	2.0565		⑧	29.52 × 1.28	37.7856	
③	12.23 × 3.28	40.1144		⑨	30.10 × 2.10	63.2100	
④	13.85 × 0.71	9.8335		⑩	30.60 × 1.43	43.7580	
⑤	15.06 × 1.46	21.9876		⑪	30.80 × 1.35	41.5800	
⑥	16.72 × 1.00	16.7200		⑫	30.85 × 1.27	39.1795	
⑦	18.62 × 1.29	24.0198		⑬	30.85 × 1.26	38.8710	
⑧	19.80 × 0.87	17.2260		⑭	36.28 × 20.45	741.9260	
⑨	21.40 × 1.46	31.2440		⑮	36.28 × 16.75	607.6900	
⑩	22.70 × 1.36	30.8720		計		1990.6743	995.33 ^坪
⑪	23.80 × 1.24	29.5120					